

## **Installing brackets on vehicles with mushroom head fixed points. Fiat Ducato, Peugeot Boxer, and Citroen Jumper**

**Slide the bracket beneath the mushroom head as depicted.**

The image on the right is already installed on your vehicle at the factory.

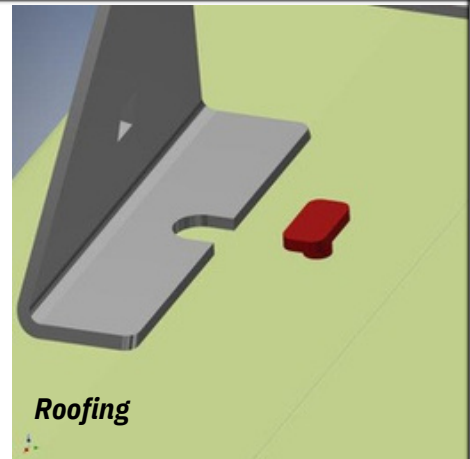

**Now insert the retaining clip between the head.**

Fungi and bracket, as depicted in the image on the right. Pull the retaining clip as near to the bracket as feasible.

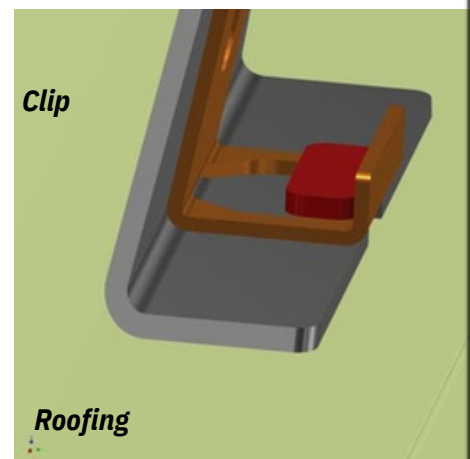

**Now fasten the M8 lock nut securely.**

Depending on your vehicle's roof surface, the supports may have a slight incline, which will be adjusted during the installation of the transverse profiles.

